

Acidity**56I700100****50 - 40000 mg/L H₂SO₄****Material**

| Reagents | Packaging Unit | Part Number |
|--------------------------------------|-----------------------|--------------------|
| Acidity / Alkalinity P Indicator PA1 | 65 mL | 56L013565 |
| Acidity HR Titrant ACD2 | 65 mL | 56L040865 |
| Acidity LR Titrant ACD3 | 65 mL | 56L013165 |

The following accessories are required.

| Accessories | Packaging Unit | Part Number |
|--|-----------------------|--------------------|
| Syringe, plastic, 20 mL | 1 Pieces | 56A006501 |
| Titration jar with cap, plastic, 60 mL | 1 Pieces | 56A006701 |

Application List

- Food and Beverage
- Disinfection Control

Remarks

1. Colours may vary depending on sample and test conditions.
2. 1 % = 10000 mg/L (ppm)
3. For other acids multiply the results by the following factor:

| | |
|-------------------|------|
| Sulphamic acid | 2.5 |
| Hydrochloric acid | 0.75 |
| Citric acid | 1.5 |
| Acetic acid | 1.25 |
| Phosphoric acid | 2.0 |
| Formic acid | 0.9 |
| Hydrofluoric acid | 0.5 |
| Nitric acid | 1.3 |

Sampling

Select the sample volume from the table according to the expected measuring range and read off the factor to calculate the result.

| Expected Range | Titrant used | Sample Size | Factor |
|-----------------------|----------------------------|--------------------|---------------|
| 50-250 mg/L | Acidity LR Titrant ACD3 | 40 mL | 12.5 |
| 100-500 mg/L | Acidity LR Titrant ACD3 | 20 mL | 25 |
| 200-1000 mg/L | Acidity LR Titrant ACD3 | 10 mL | 50 |
| 400-2000 mg/L | Acidity LR Titrant ACD3 | 5 mL | 100 |
| 500-2500 mg/L | Acidity HR Titrant ACD2 | 40 mL | 125 |
| 1000-5000 mg/L | Acidity HR Titrant ACD2 | 20 mL | 250 |
| 2000-10000 mg/L | Acidity HR Titrant ACD2 | 10 mL | 500 |
| 4000-400000 mg/L | Acidity HR Titrant ACD2 | 5 mL | 1000 |

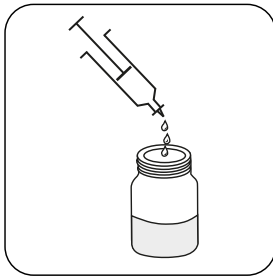

Attention! Select the appropriate sample volume according to the instructions in the chapter Sampling.



Add 2 drops of **Acidity/Alkalinity P Indicator PA1** per 10 mL of sample.



Swirl to mix.

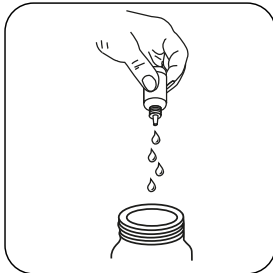

Attention! Record the number of drops that will be added.

Note: Make sure to swirl the jar after adding each drop!

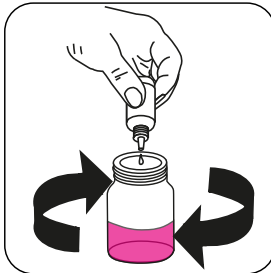

Add drops of **Acidity HR Titrant ACD2** or **Acidity LR Titrant ACD3** to give a pink colour.

Calculate test result: Acidity (as H_2SO_4) mg/L = Number of drops x factor (see table)